

# RM6201-8+4 CR+CL

# RM6201-8+4 CR+CL

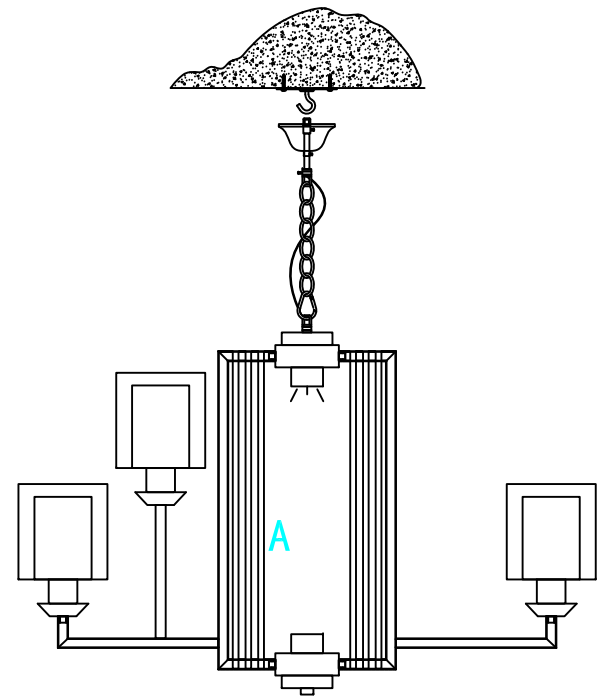
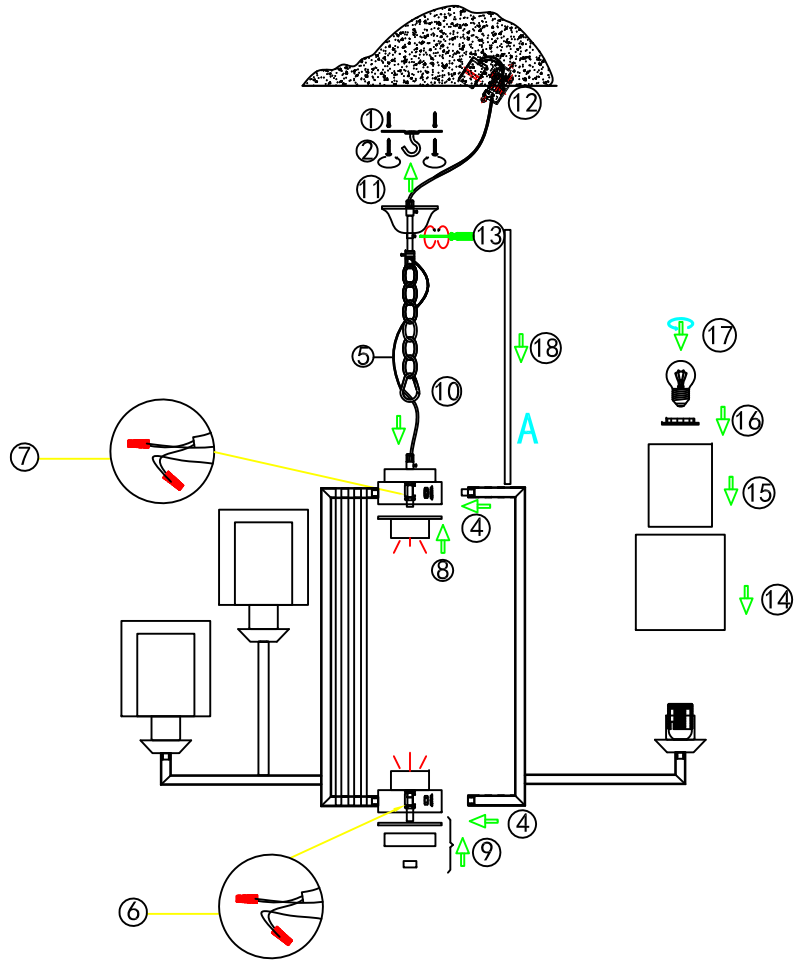
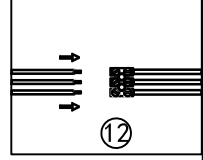
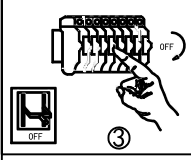

∅910\*H600mm

1. please turn off the power supply before installation
2. please take gloves to assemble the light
3. inspecting if wire connections are correct before turning on
4. please hang the light in dry place

Installation Pack	
White gloves	1PC
Hanging plate	1PC
Terminal cap	2PCS
Screw	2PCS
Expansion screws	2PCS

Crystal	
Glass:A	24PCS